



RA12-134 (12V134Ah)

RA12-134 is a general purpose battery with 10 years design life time in float charging use. As with all Ritar batteries, all RA models are rechargeable, highly efficient, leak proof and maintenance free.



Specification

Cells Per Unit	6
Voltage Per Unit	12
Capacity	134Ah @ 10hr-rate to 1.75V per cell @ 25°C
Weight	Approx. 41.5 Kg
Max. Discharge Current	600 A (5 sec)
Internal Resistance	Approx. 4.5 mΩ
Operating Temperature Range	Discharge: -20°C~60°C Charge: 0°C~50°C Storage: -20°C~60°C
Normal Operating Temperature Range	25°C±5°C
Float charging Voltage	13.6 to 13.8 VDC/unit Average at 25°C
Recommended Maximum Charging Current Limit	36 A
Equalization and Cycle Service	14.4 to 15.0 VDC/unit Average at 25°C
Self Discharge	RITAR batteries can be stored for more than 6 months at 25°C. Please charge batteries before using. For higher temperature, the time interval will be shorter.
Terminal	Faston F12/Thread insert & Bolt
Container Material	A.B.S. (UL94-HB) Flammability resistance of UL94-V1 can be available upon request.



Dimensions

Unit: mm

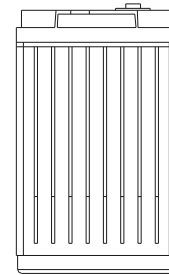
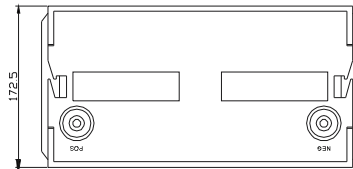
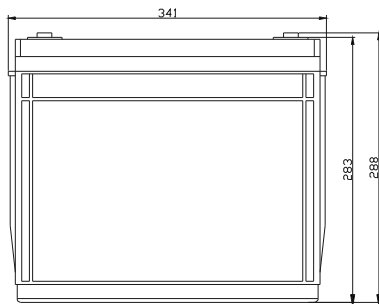

Terminal F12

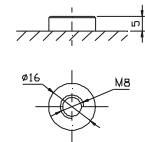

Constant Current Discharge Characteristics Unit: A(25°C)

F.V/Time	5MIN	10MIN	15MIN	30MIN	1HR	2HR	3HR	4HR	5HR	8HR	10HR	20HR
1.60V	501	359	261	154	87.1	53.5	35.0	28.9	22.8	16.5	13.9	7.4
1.67V	488	342	256	152	86.7	53.1	34.8	28.8	22.6	16.3	13.8	7.2
1.70V	460	330	252	150	85.9	52.7	34.6	28.7	22.5	16.2	13.7	7.1
1.75V	413	304	240	146	85.1	52.3	34.4	28.4	22.2	16.1	13.5	7.0
1.80V	373	277	221	140	83.1	51.3	33.5	27.7	21.8	15.8	13.4	6.8
1.85V	324	248	198	131	78.9	49.0	32.0	26.4	20.9	15.1	13.0	6.4

Constant Power Discharge Characteristics Unit: W(25°C)

F.V/Time	5MIN	10MIN	15MIN	30MIN	1HR	2HR	3HR	4HR	5HR	8HR	10HR	20HR
1.60V	898	657	484	290	166.0	102.5	67.3	55.7	44.0	31.9	26.1	13.8
1.67V	880	628	474	286	165.2	102.1	67.1	55.6	43.7	31.8	25.9	13.7
1.70V	831	607	467	283	164.0	101.2	66.7	55.3	43.6	31.5	25.7	13.5
1.75V	748	561	446	276	162.4	100.2	66.3	54.9	43.1	31.2	25.5	13.4
1.80V	673	509	409	264	158.4	98.8	64.7	53.5	42.5	30.6	25.2	13.3
1.85V	581	452	366	247	150.1	94.2	61.5	50.9	40.3	29.5	24.4	12.7

All mentioned values are average values.

Temperature effects curve

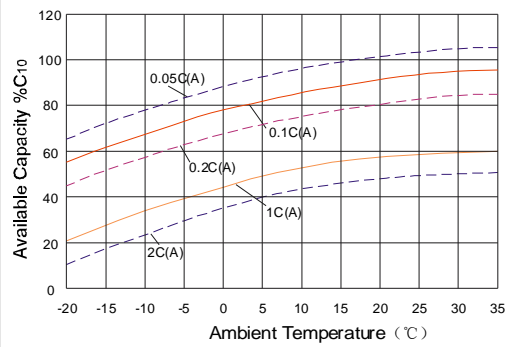

Storage characteristic

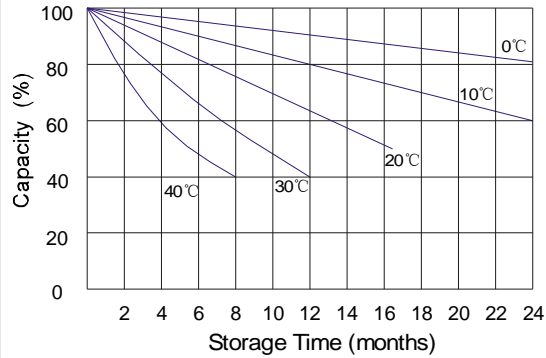

Supplementary charge required (Carry out supplementary charge before use if 100% capacity is required)

Supplementary charge required before use. This supplementary charge will help to recover the capacity and should be made as early as possible.

Supplementary charge may often fail to recover the capacity. The battery should never be left standing till this state is reached

Supplementary charge and storage guidelines

Life characteristics of cyclic use

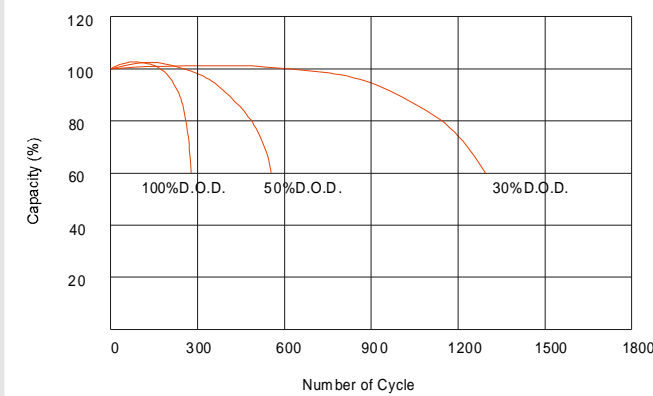

Effect of temperature on long term float life

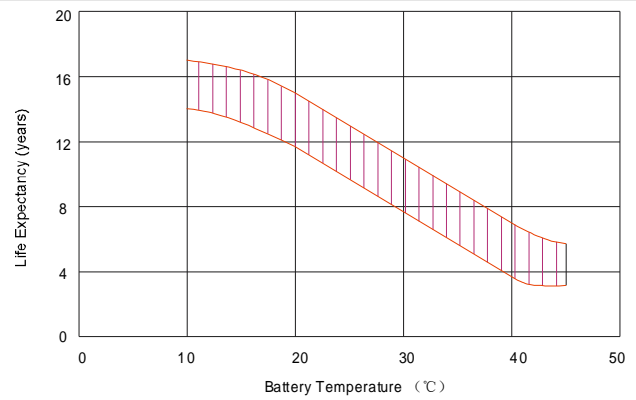

Charge characteristic Curve for standby use

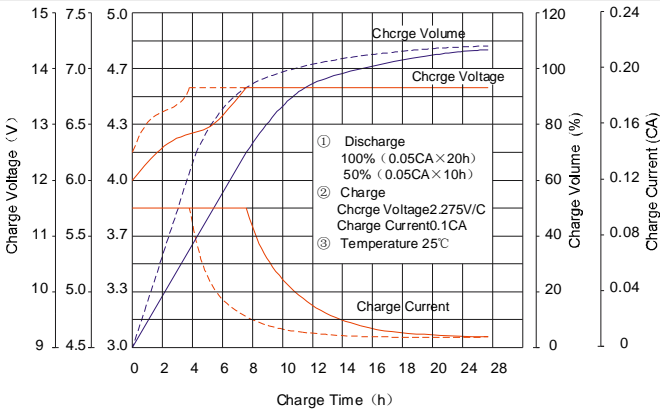

Discharge characteristic Curve

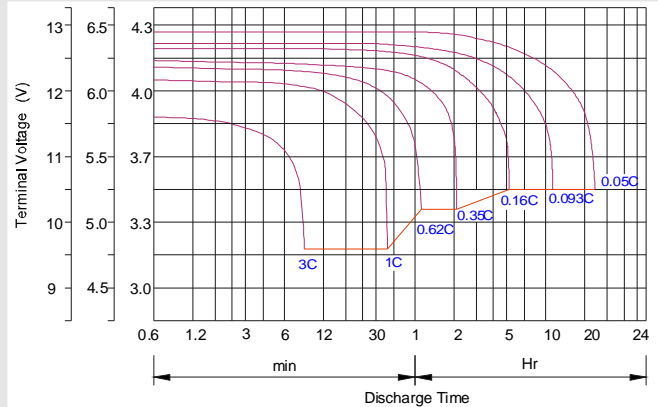

Charging Procedures(12V series)

Application	Charge Voltage (V)			Max. Charge Current
	Temperature	Set point	Allowable range	
Cycle Use	25°C	14.7	14.4~15.0	0.3C
Standby	25°C	13.7	13.6~13.8	0.3C

Discharge Current VS. Discharge Voltage

Final Discharge Voltage V/cell	1.75V	1.70V	1.60V
Discharge Current (A)	(A) ≤ 0.2C	0.2C < (A) < 1.0C	(A) ≥ 1.0C

Charge the batteries at least once every six months, if they are stored at 25°C.

Charging Method:

Constant Voltage	-0.2Cx2h +14.4~15.0V,24h,Max. Current 0.3CA
Constant Current	-0.2Cx2h +0.1CAx10h
Fast	-0.2Cx2h +0.3CAx3.5h

Charging Procedures(6V series)

Application	Charge Voltage (V)			Max. Charge Current
	Temperature	Set point	Allowable range	
Cycle Use	25°C	7.35	7.25~7.45	0.3C
Standby	25°C	6.85	6.8~6.9	0.3C

SHEN ZHEN RITAR POWER CO.,LTD.

Room 405,Tower C,Huahan Building,Jiangshan Road 16,North High-tech Industrial Park, Nanshan District,Shenzhen,518057,China

URL:www.ritarpower.com Tel:+86-755-33981668 Fax:86-755-83475180