



RA12-134G (12V134Ah)

RA12-134G is GEL Standby battery with 12 years+ design life time in float charging use. Ritar Gel battery are featured with low self-discharge, good consistence on deep discharge, long cyclic life, low floating charging voltage and current, free from erosion, pollution, gas escape, and leakage, as well as beneficial to environmental protection.



Specification

Cells Per Unit	6
Voltage Per Unit	12
Capacity	134Ah@10hr-rate to 1.75V per cell @25°C
Weight	Approx. 46.1 Kg
Max. Discharge Current	600 A (5 sec)
Internal Resistance	Approx. 9.0 mΩ
Operating Temperature Range	Discharge: -30°C~60°C Charge: -20°C~50°C Storage: -30°C~60°C
Normal Operating Temperature Range	25°C±5°C
Float charging Voltage	13.6 to 13.8 VDC/unit Average at 25°C
Recommended Maximum Charging Current Limit	36 A
Equalization and Cycle Service	14.1 to 14.3 VDC/unit Average at 25°C
Self Discharge	RITAR batteries can be stored for more than 12 months at 25°C. Please charge batteries before using. For higher temperature, the time interval will be shorter.
Terminal	Faston F12/Thread insert & Bolt
Container Material	A.B.S. (UL94-HB) Flammability resistance of UL94-V1 can be available upon request.



Dimensions

Unit: mm

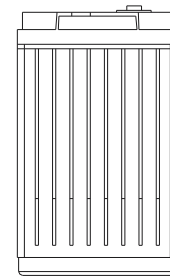
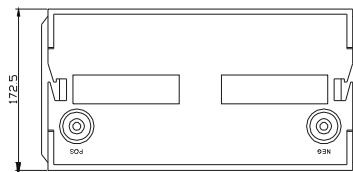
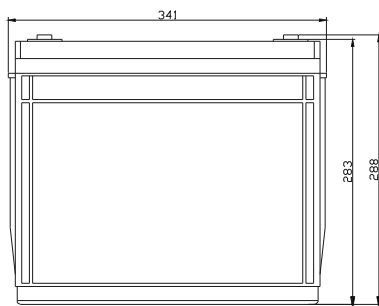

Terminal F12

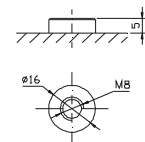

Constant Current Discharge Characteristics Unit: A(25°C)

F.V/Time	5MIN	10MIN	15MIN	30MIN	1HR	2HR	3HR	4HR	5HR	8HR	10HR	20HR
1.60V	459	329	239	141	81.4	50.0	32.7	27.1	21.3	16.0	13.5	7.1
1.67V	446	313	234	139	81.1	49.6	32.6	26.9	21.2	15.9	13.4	7.0
1.70V	421	302	231	137	80.3	49.2	32.3	26.8	21.0	15.7	13.3	6.9
1.75V	378	278	219	134	79.6	48.9	32.2	26.6	20.8	15.6	13.1	6.8
1.80V	341	254	202	128	77.7	48.0	31.3	25.9	20.4	15.3	13.0	6.6
1.85V	297	227	181	120	73.8	45.9	29.9	24.7	19.5	14.7	12.6	6.2

Constant Power Discharge Characteristics Unit: W(25°C)

F.V/Time	5MIN	10MIN	15MIN	30MIN	1HR	2HR	3HR	4HR	5HR	8HR	10HR	20HR
1.60V	822	601	443	265	155.2	95.8	62.9	52.1	41.1	30.9	25.3	13.4
1.67V	805	574	433	262	154.5	95.5	62.8	52.0	40.8	30.8	25.1	13.3
1.70V	760	555	428	259	153.4	94.6	62.4	51.7	40.7	30.5	25.0	13.1
1.75V	685	513	408	253	151.9	93.7	62.0	51.4	40.3	30.3	24.7	13.0
1.80V	616	466	375	241	148.1	92.3	60.5	50.0	39.7	29.6	24.4	12.9
1.85V	532	414	334	226	140.3	88.1	57.5	47.6	37.7	28.6	23.7	12.3

All mentioned values are average values.

RA12-134G

12V134Ah



Temperature effects curve

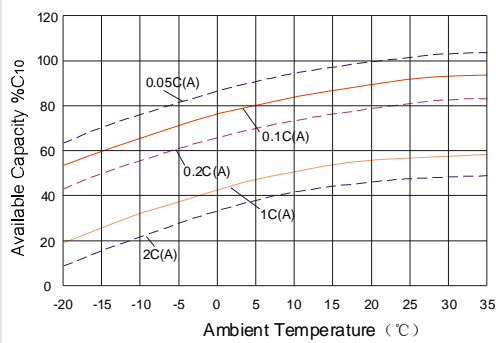

Storage characteristic

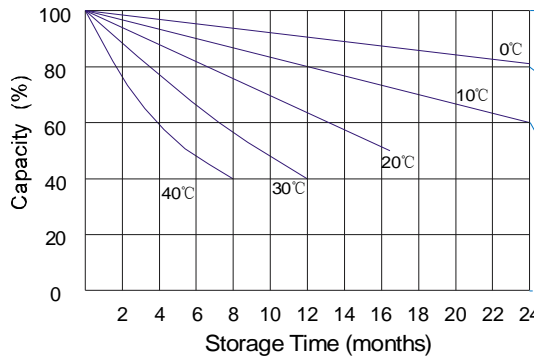

Supplementary charge required (Carry out supplementary charge before use if 100% capacity is required)

Supplementary charge required before use. This supplementary charge will help to recover the capacity and should be made as early as possible.

Supplementary charge may often fail to recover the capacity. The battery should never be left standing till this state is reached

Supplementary charge and storage guidelines

Life characteristics of cyclic use

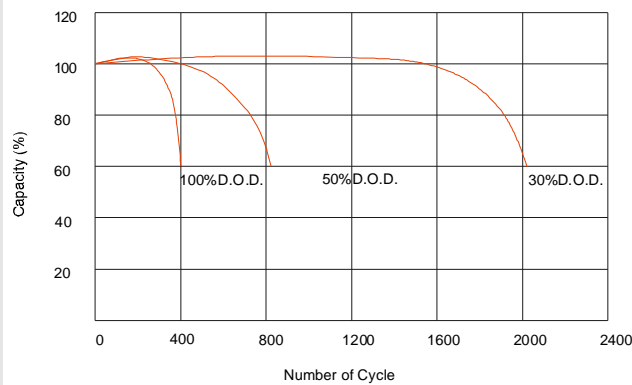

Effect of temperature on long term float life

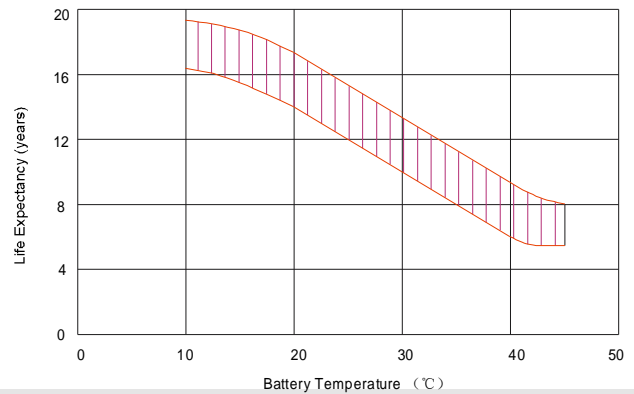

Charge characteristic Curve for standby use

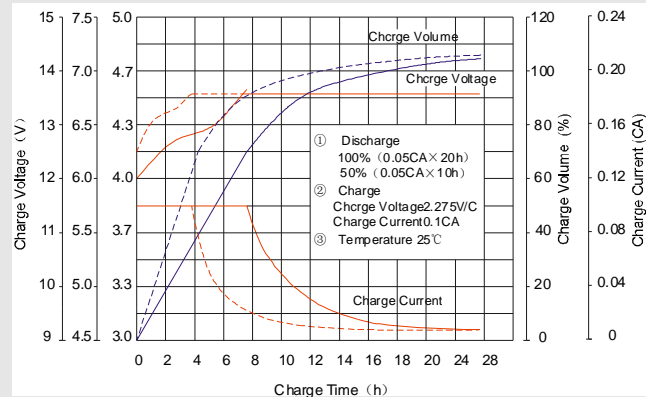

Discharge characteristic Curve

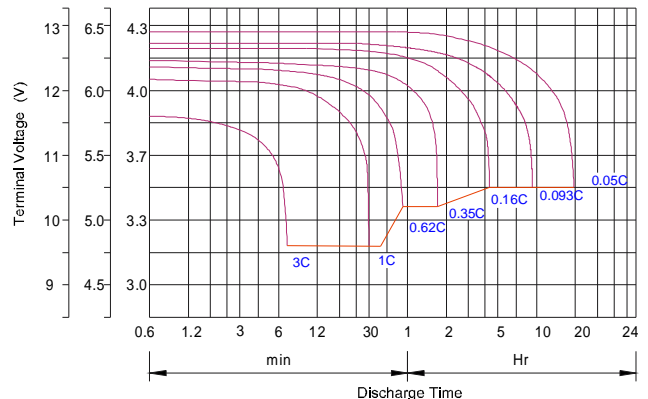

Charging Procedures(12V series)

Application	Charge Voltage (V)			Max. Charge Current
	Temperature	Set point	Allowable range	
Cycle Use	25°C	14.2	14.1~14.3	0.3C
Standby	25°C	13.7	13.6~13.8	0.3C

Discharge Current VS. Discharge Voltage

Final Discharge Voltage V/cell	1.75V	1.70V	1.60V
Discharge Current (A)	(A) ≤ 0.2C	0.2C < (A) < 1.0C	(A) ≥ 1.0C

Charge the batteries at least once every six months, if they are stored at 25°C.

Charging Method:

Constant Voltage	-0.2Cx2h +14.1~14.3V,24h,Max. Current 0.2CA
Constant Current	-0.2Cx2h +0.1CAx12h

Charging Procedures(6V series)

Application	Charge Voltage (V)			Max. Charge Current
	Temperature	Set point	Allowable range	
Cycle Use	25°C	7.10	7.05~7.15	0.3C
Standby	25°C	6.85	6.8~6.9	0.3C

SHEN ZHEN RITAR POWER CO.,LTD.

Room 405, Tower C, Huahan Building, Langshan Road 16, North High-tech Industrial Park, Nanshan District, Shenzhen, 518057, China

URL: www.ritarpower.com Tel: +86-755-33981668 Fax: 86-755-83475180